

CBX ADDENDUM



ADDENDUM



1. PRIMARY SHAFT (COLLET TYPE DRIVEN SPROCKET)

On and after Eng. No. CBIE-2020729

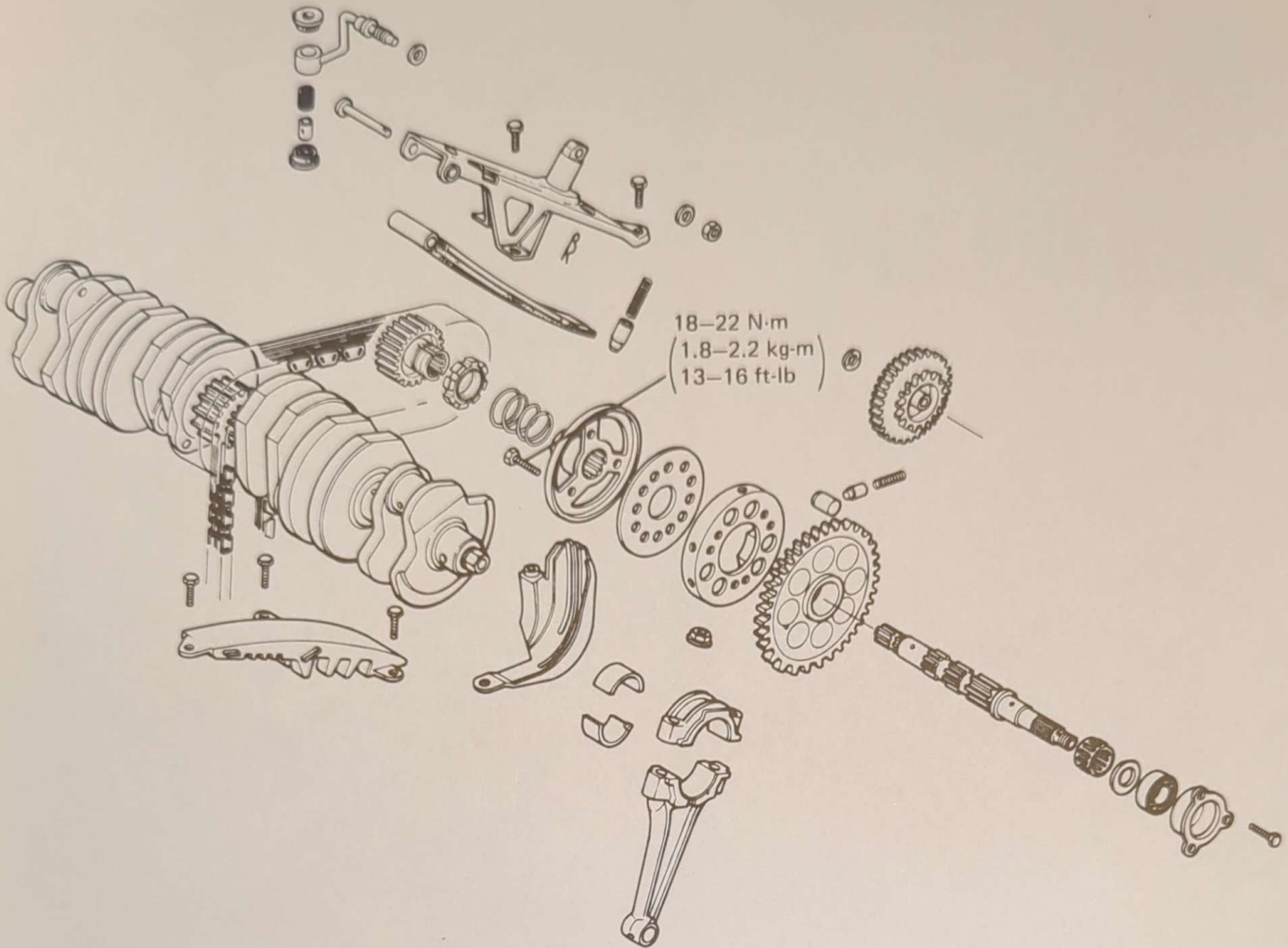

PRIMARY SHAFT REMOVAL

Temporarily assemble the drive gear on the primary shaft and block the shaft with the special "PRIMARY GEAR HOLDER" tool. Loosen the primary driven sprocket collet ring nut with the special "PIN SPANNER" tool.

NOTE

The ring nut has left-hand threads.

Remove the drive gear and then primary shaft.

